

# Registration

## Registration

Early Registration	December 20 (Tue.), 2016 – March 24 (Fri.), 2017
Late Registration	March 25 (Sat.) – May 7 (Sun.), 2017
On-site Registration	May 25 (Thu.) – 26 (Fri.), 2017

## Registration Desk

Date	Opening Hours	Place
May 25 (Thu.), 2017	8:00-17:00	1F Foyer
May 26 (Fri.), 2017	8:00-15:30	

## Registration Fee

	Early Registration	Late Registration
Regular	30,000JPY	35,000JPY
Student*	5,000JPY	

\* Banquet fee included

You will be provided with a name badge, and congress kit when you register at the Registration Desk.

All participants are requested to wear their name badges at all times within the Summit venue.

## Banquet

**Date and Time:** May 25 (Thu.), 2017 19:00-21:00

**Venue:** Tenku, B1F, Tokyo Dome Hotel

Banquet fee: 2,000JPY

\*Registration starts from 18:30.

## Summit Venue

- (1) Smoking is prohibited in the Summit venue. (Smoking Room in 2F is excluded.)
- (2) Photographing and audio recording without the permission are prohibited.
- (3) Please set your cell phones into silent mode or turn off during the sessions.
- (4) Wi-Fi service is provided for the entire area with limited access.
- (5) There is no cloakroom in the Summit venue. Please keep all your belongings with you.
- (6) Please visit the Registration Desk for lost and found.
- (7) Interpretation service (ENG-JPN) is provided at Hall 1 for Opening Session, Closing Session, Plenary Sessions, and several Parallel Sessions.
- (8) Interpretation receivers are available at Hall 1. When you enter the Summit venue, please hand in your tickets to have your receivers and return it at the end of the day.
- (9) There is no Business Center in the Summit venue. Coin operated copiers are available on 2F.

## Booth Exhibition

Exhibition area is located at Coffee Break & Exhibition Hall (2F).

Opening Hours:

May 25 (Thu.) 8:45-18:00

May 26 (Fri.) 9:00-16:30

<Booth Exhibition List>

1. Elsevier
2. IBM Japan, Ltd.
3. The Sasakawa Peace Foundation
4. NAGOYA UNIVERSITY
5. Tohoku University

## Lunch

Boxed lunch is served in Hall 2 (2F), Hall 3 (1F) and Hall 4 (2F) at the following periods:

May 25 (Thu.) 12:45-13:45

May 26 (Fri.) 12:30-13:15

\*When you enter the lunch venue, please show your name badge and have your boxed lunch.

\*Vegetarian and Halal Friendly Boxed Lunches are prepared based on pre-registration. For other participants who have dietary restriction, please understand that limited numbers are available on first-come-first-served basis. Please visit the Registration Desk for further details.

# Venue Allocation

## 1F, National Center of Sciences

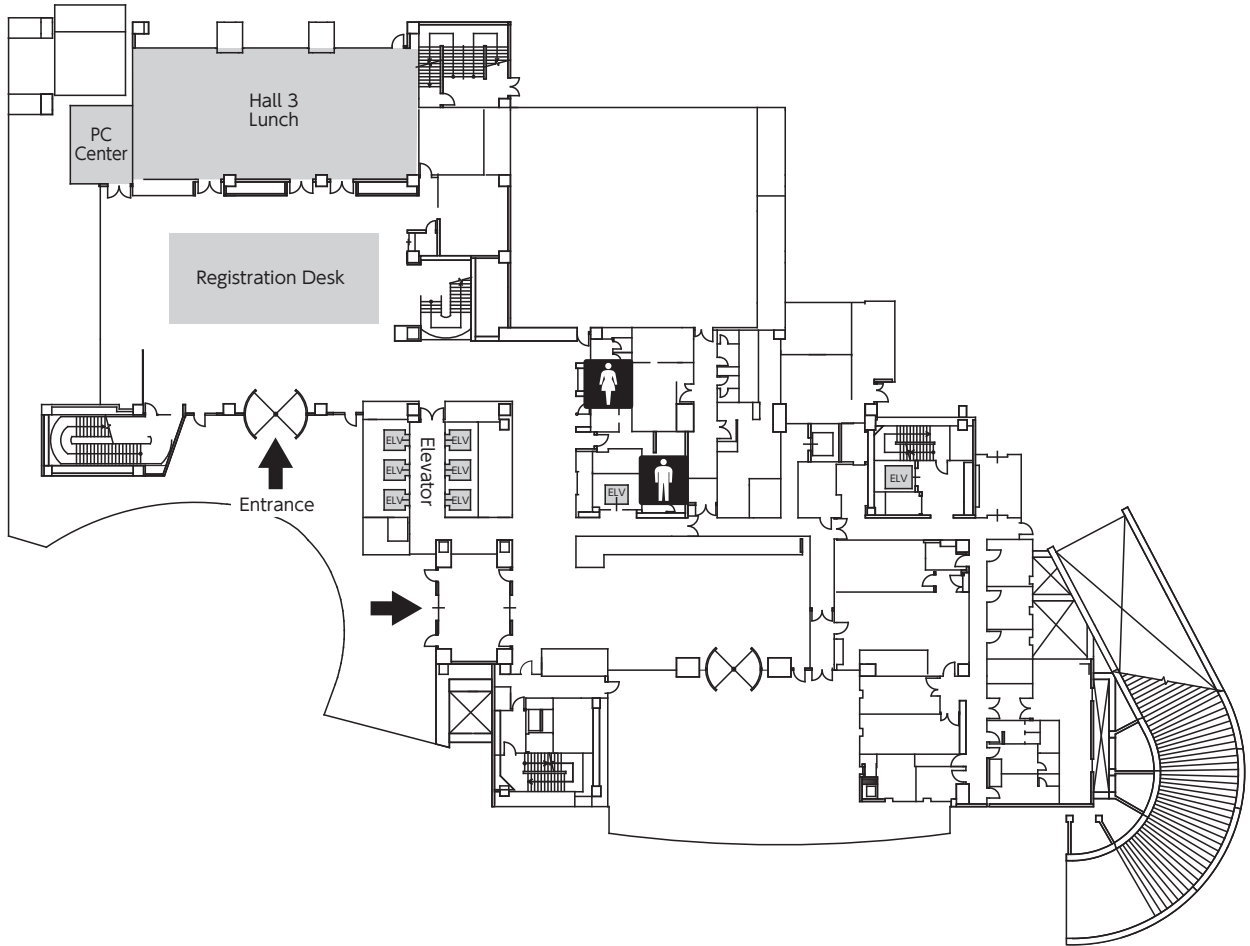

2F, National Center of Sciences

May 25 (Thu.), 2017

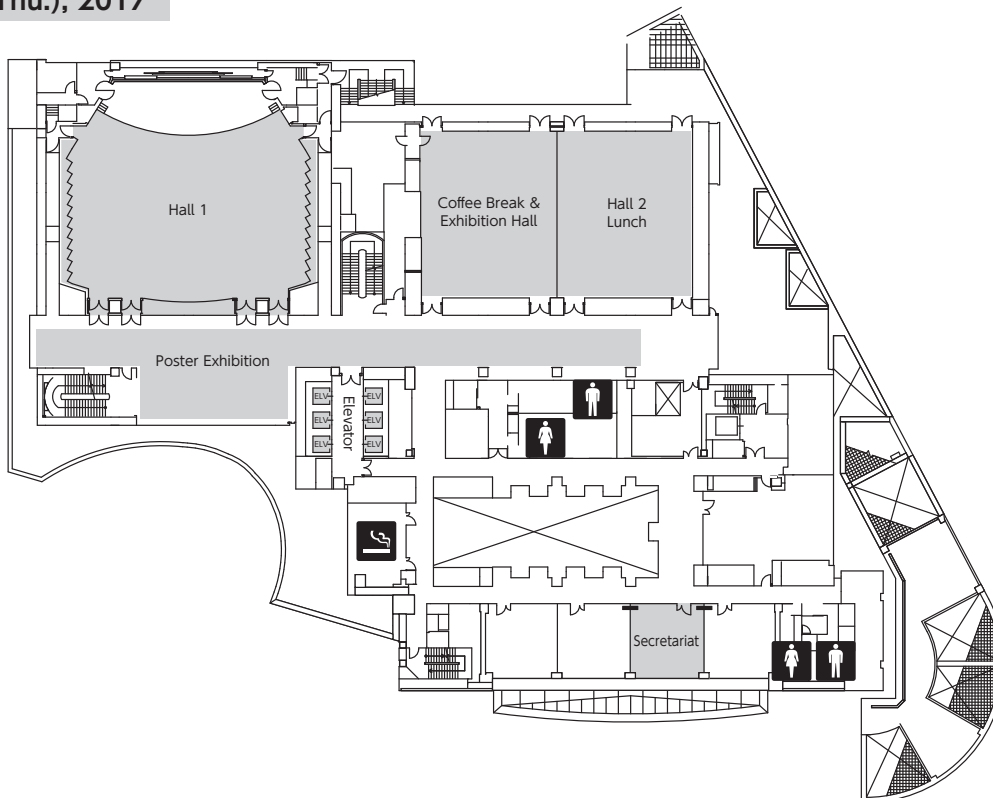

May 26 (Fri.), 2017

